





WELLS CREEK
CONCEPTUAL PUD SITE PLAN
AUGUST 21, 2017

LEGEND

-  COMMUNITY IDENTIFICATION MONUMENT SIGNS
-  POTENTIAL ACCESS POINTS
-  APPROXIMATE WETLAND AREAS
(ACTUAL LOCATION TO BE DETERMINED BY WMD)
-  CONSERVATION AREA

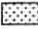
THE LOCATION AND DESIGN OF THE PROPOSED ROADS, ANY TRAFFIC CIRCLES, INTERSECTIONS, AND ACCESS POINTS AS SHOWN ON THE PUD SITE PLAN IS SCHEMATIC AND MAY BE SUBJECT TO REALIGNMENT PRIOR TO DEVELOPMENT.

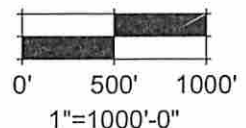
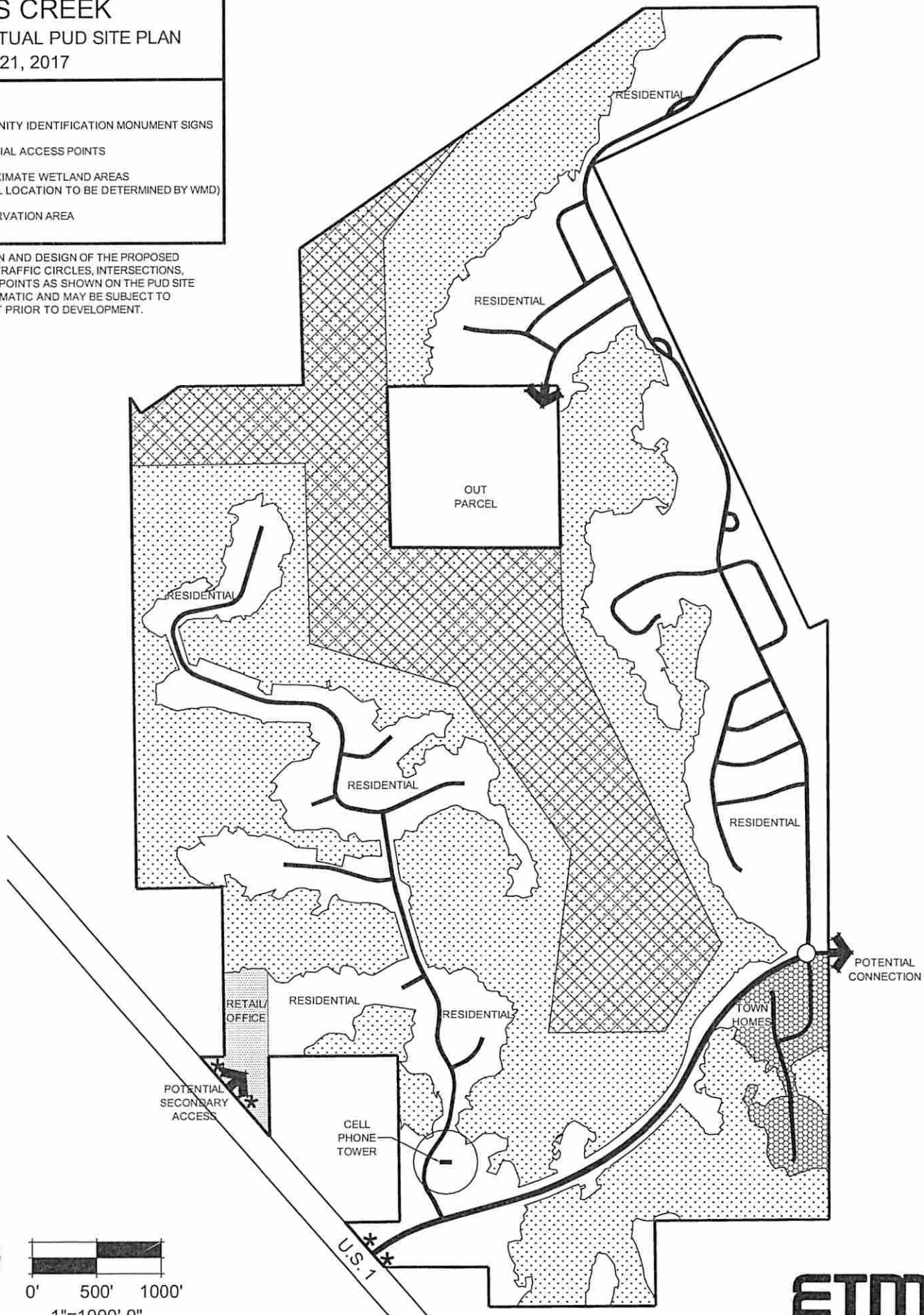
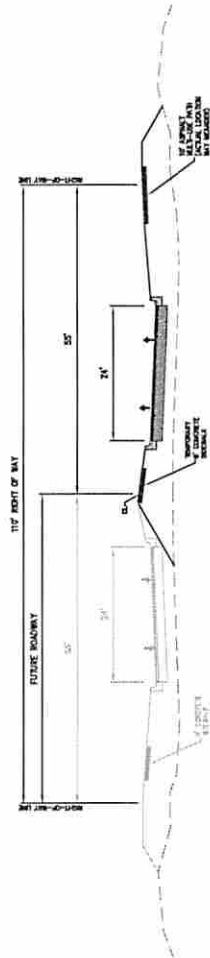
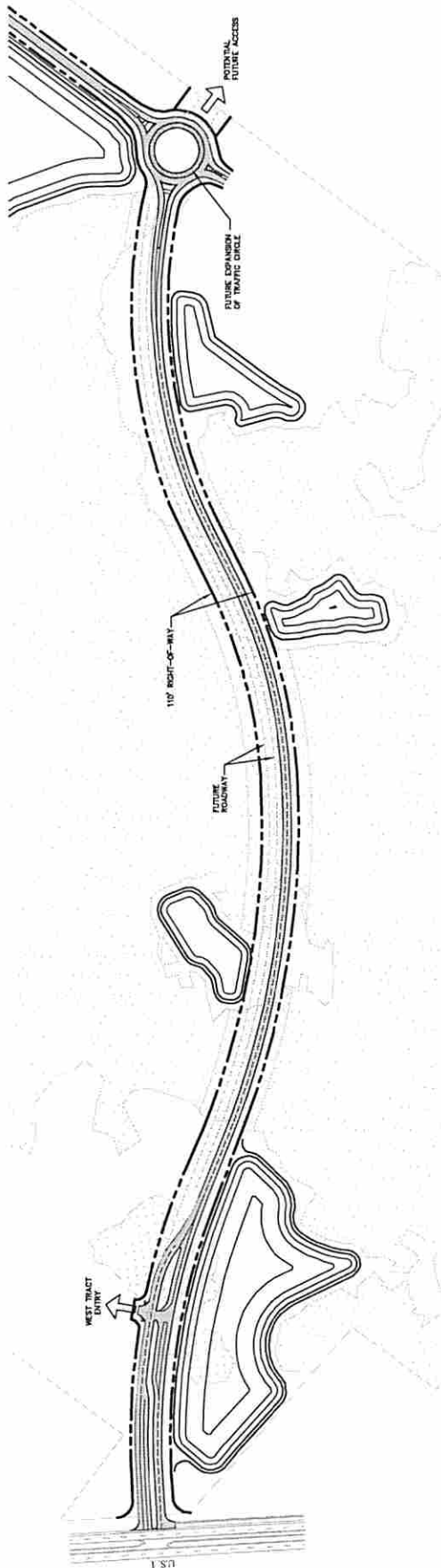

Exhibit "E"



WELLS CREEK
 SEPTEMBER 18, 2017



**COLLECTOR ROAD
 TYPICAL SECTION**

N.A.S.
 ALL DIMENSIONS ARE IN FEET UNLESS OTHERWISE NOTED.
 CITY OF SACRAMENTO DEPARTMENT OF PUBLIC WORKS
 RIGHT-OF-WAY



Exhibit "E-1"

WELLS CREEK
BICYCLE / PEDESTRIAN CIRCULATION PLAN,
EASTERLY SECTION
AUGUST 18, 2017

- 10' MULTI-USE PATH
- |---|---|---|---|--- 6' SIDEWALK
- 5' SIDEWALK

